

# TOP JAMB INSTALLATION CLOSER MOUNTED TOP JAMB ON PUSH SIDE OF DOOR

1 a.Choose degree of door opening b.Drill per screw chart

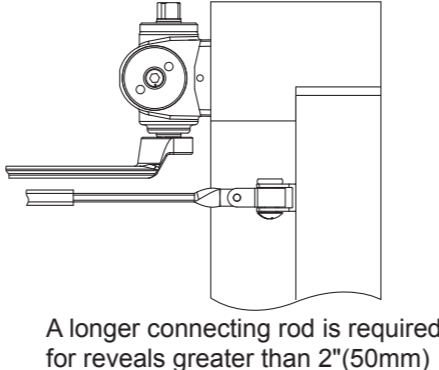
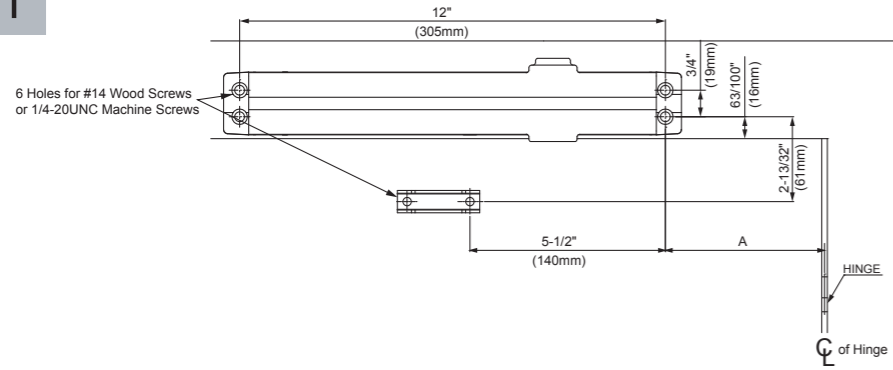

LEFT HAND DOOR ILLUSTRATED

Opening	Dimensions "A"
To 100°	7-1/2" (191 mm)
To 130°	6" (152 mm)
To 180°	4-1/2" (114 mm)

Adjust spring power to match chart

Opening	Closer Size	Number of Turns	Closer Size	Number of Turns
To 100°	III	0	VI	+12
	II	-5	V	+9
	I	-9	IV	+4
To 130°	III	0	VI	+14
	II	-4	V	+10
	I	-9	VI	+5
To 180°	III	0	VI	+15
	II	-5	V	+10
	I / 1/2	-10 / -11	IV	+5

Door Closer Size I is not covered by CAN/ULC S133 since it is not intended for use with swinging doors in fire separations and on exit doors.

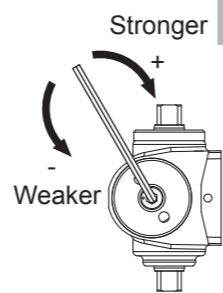

2

# STANDARD INSTALLATION CLOSER MOUNTED ON PULL SIDE OF DOOR

1 a.Choose degree of door opening b.Drill per screw chart

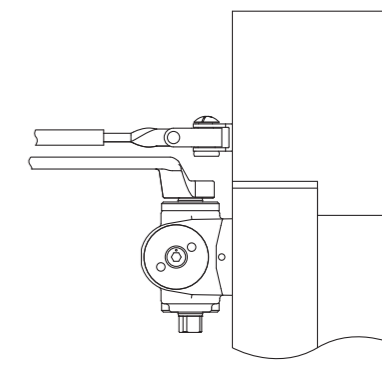
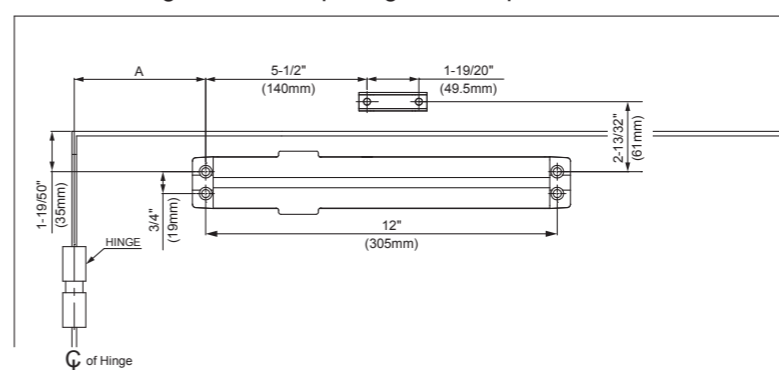

RIGHT HAND DOOR ILLUSTRATED

Opening	Dimensions "A"
To 100°	7-1/2" (191 mm)
To 130°	6" (152 mm)
To 180°	4-1/2" (114 mm)

Adjust spring power to match chart

Opening	Closer Size	Number of Turns	Closer Size	Number of Turns
To 100°	III	0	VI	+12
	II	-5	V	+9
	I	-9	IV	+4
To 130°	III	0	VI	+14
	II	-4	V	+10
	I	-9	VI	+5
To 180°	III	0	VI	+15
	II	-5	V	+10
	I / 1/2	-10 / -11	IV	+5

Door Closer Size I is not covered by CAN/ULC S133 since it is not intended for use with swinging doors in fire separations and on exit doors.

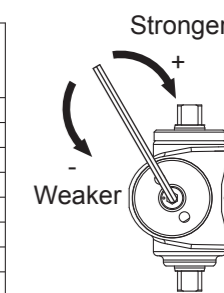

2

3 a → b → c → d → e → f

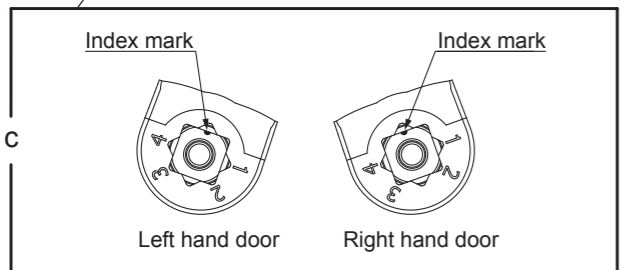
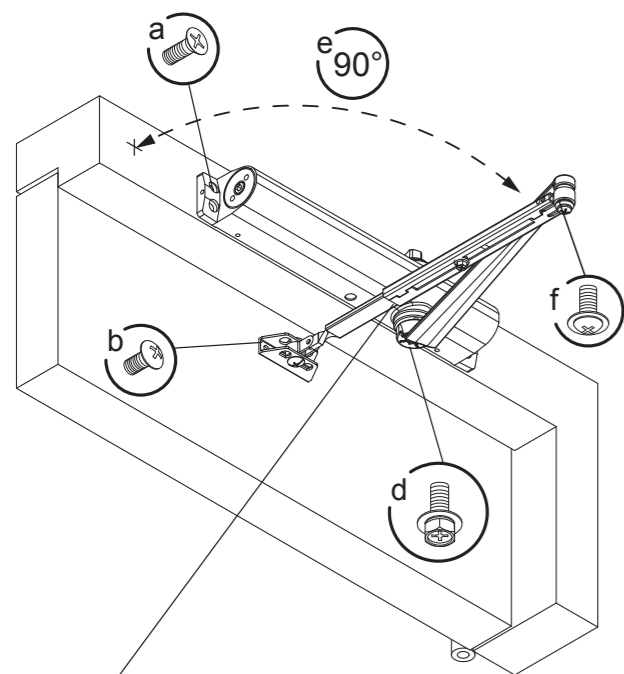

4

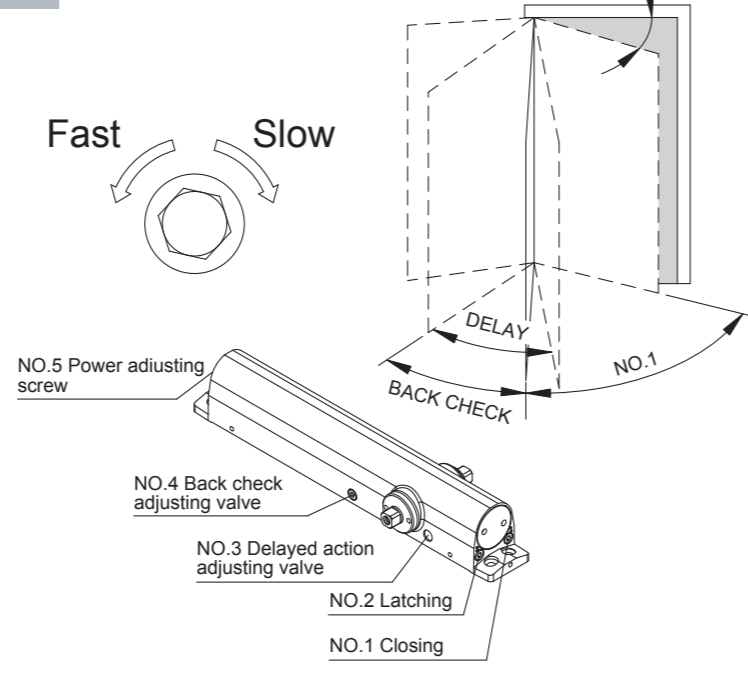

5 Plastic Cover

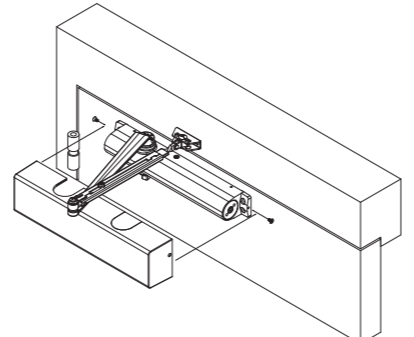

3 a → b → c → d → e → f

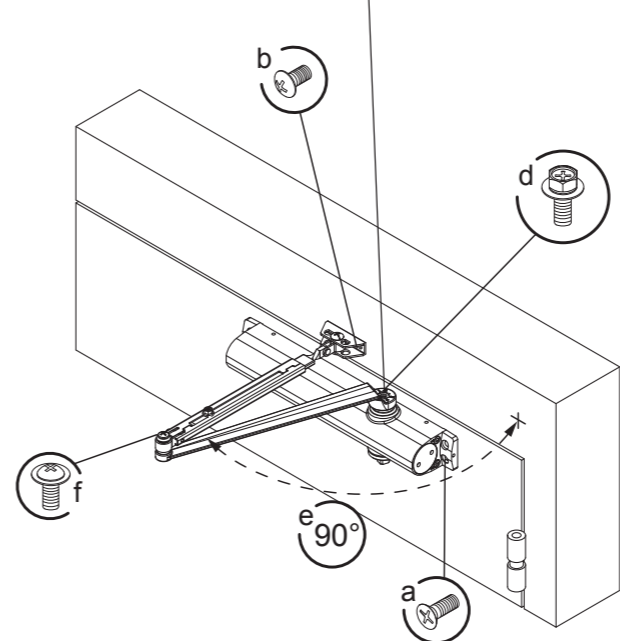
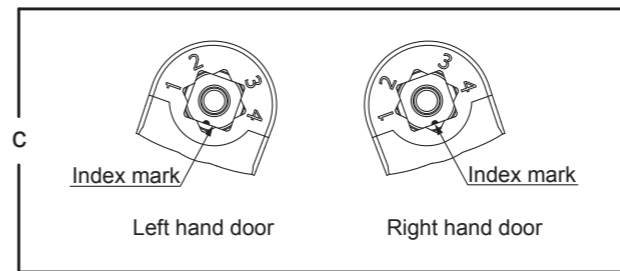

4

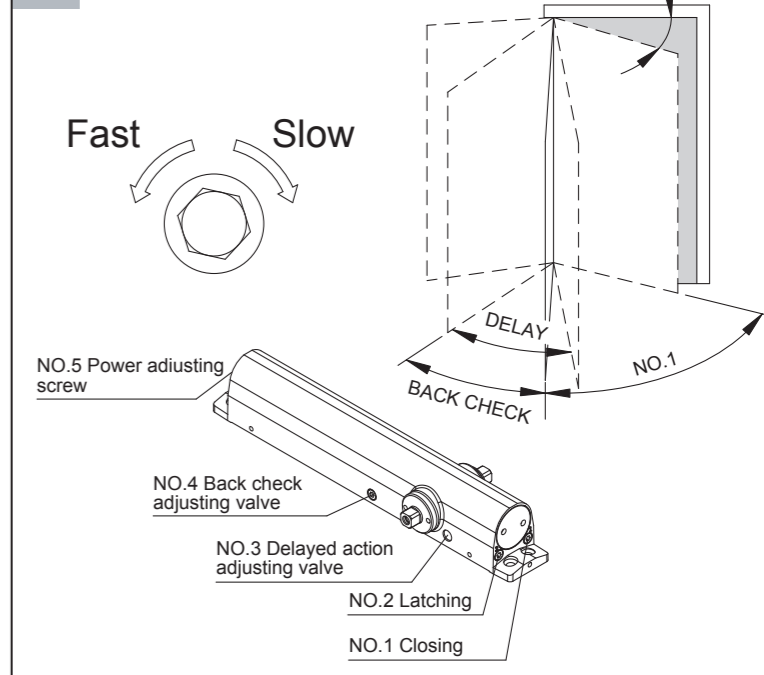

5 Plastic Cover

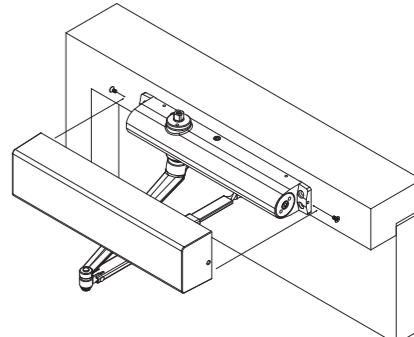

# PARALLEL ARM INSTALLATION CLOSER MOUNTED ON PUSH SIDE OF DOOR

1 a. Choose degree of door opening b. Drill per screw chart.

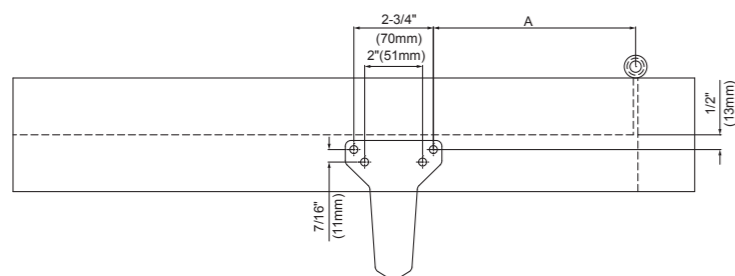

RIGHT HAND DOOR ILLUSTRATED

Opening	Dimensions "A"	Dimensions "B"
To 120°	9-1/2"(241mm)	3-3/4"(95mm)
To 180°	7"(178mm)	1-1/4"(32mm)

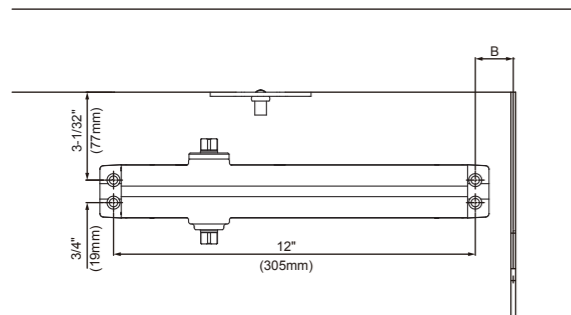

Adjust spring power to match chart.

Opening	Closer Size	Number of Turns	Closer Size	Number of Turns
To 120°	III	0	V	+13
	II	-5	IV	+6
	I	-11		
To 180°	III	0	V	+13
	II	-4	IV	+7
	I	-10		

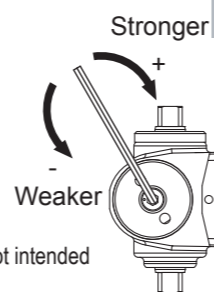

Door Closer Size I is not covered by CAN/ULC S133 since it is not intended for use with swinging doors in fire separations and on exit doors.

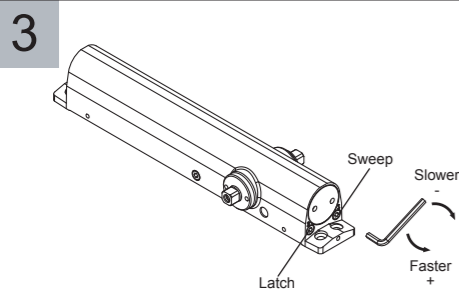

4 a → b → c

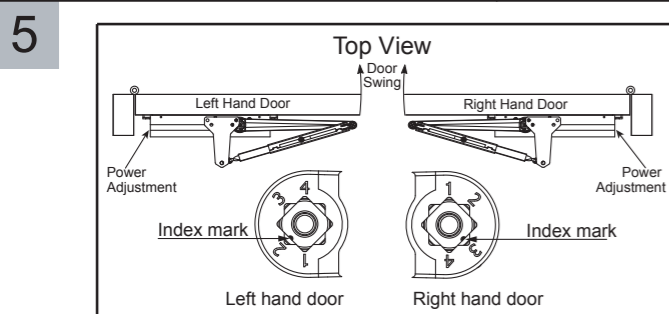
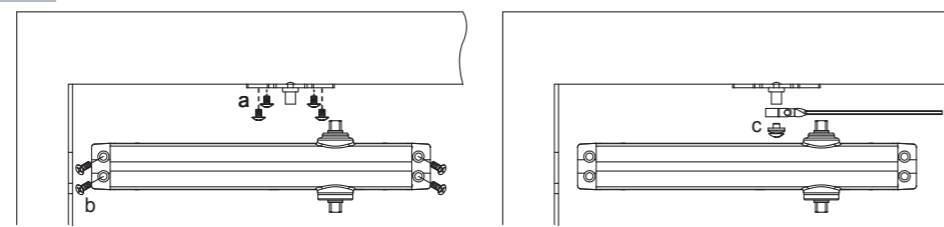

a → b → c → d → e → f

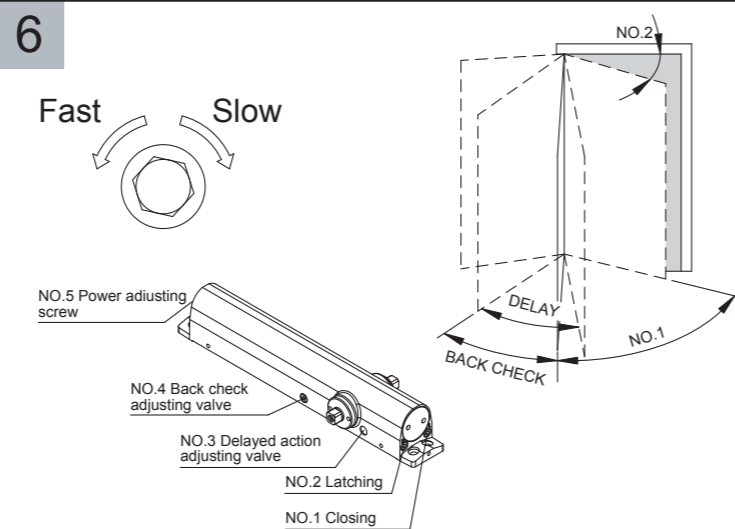
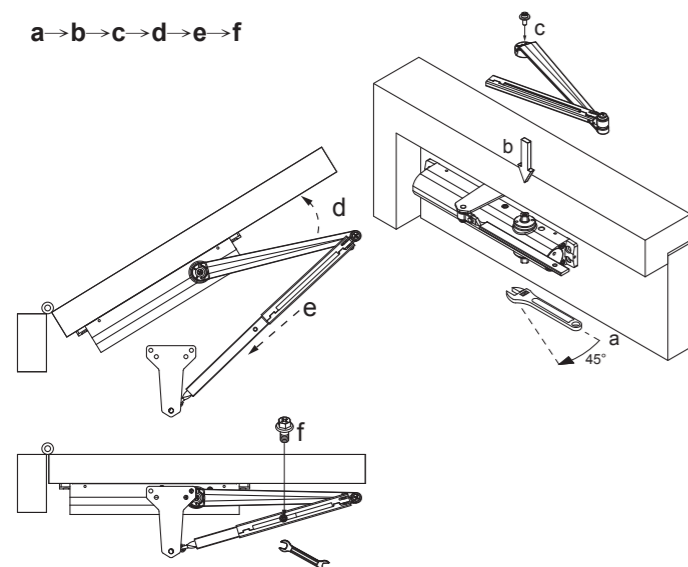

7 Plastic Cover

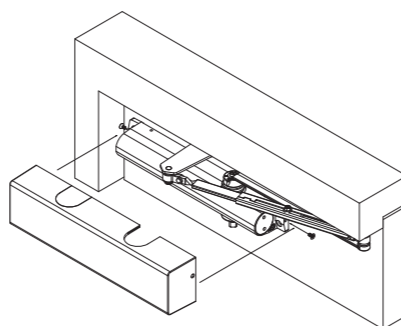

## Pull Side Installation

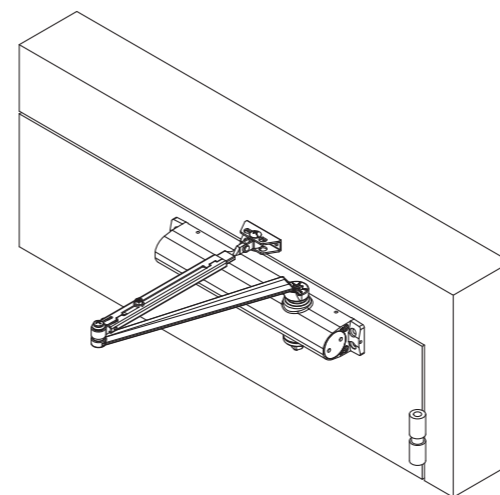

## Push Side Installation

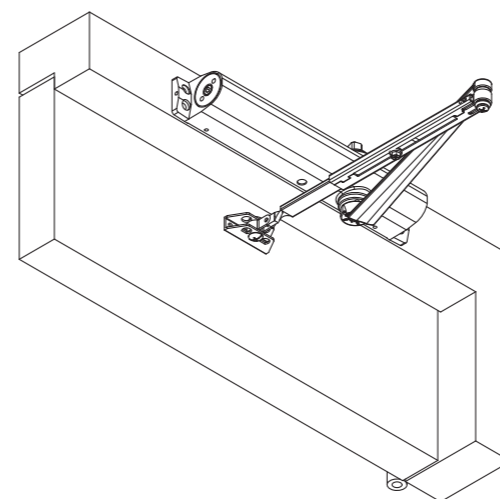

## Parallel Arm Installation

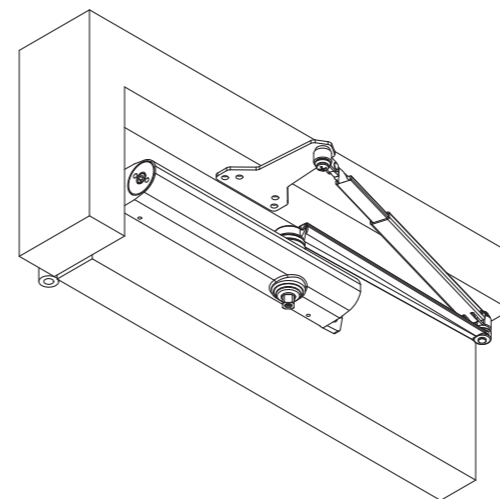

## DOOR CLOSER INSTALLATION INSTRUCTION

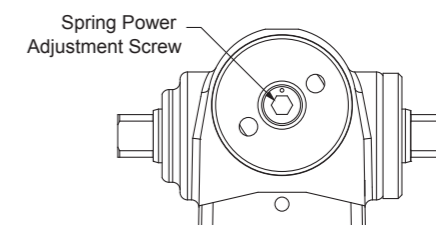
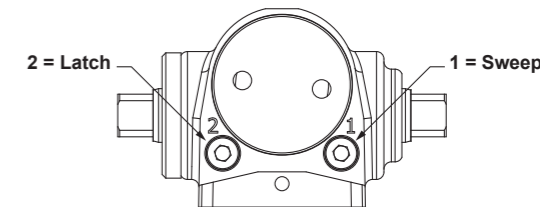

Adjustment Chart	DOOR	INTERIOR		EXTERIOR	
	TYPE OF INST.	Regular Arm Top Jamb	Parallel Arm	Regular Arm Top Jamb	Parallel Arm
Number of Turns Required DOOR SIZE (INCHES)	24" - 30" (61 cm - 76 cm)	-11	-3	-4	0
	30" - 34" (76 cm - 86 cm)	-5	0	0	7
	34" - 38" (86 cm - 97 cm)	0	5	6	13
	38" - 48" (97 cm - 122 cm)	5	10	12	
	48" - 54" (122 cm - 137 cm)	10	15		
	54" - 60" (137 cm - 152 cm)	15			

NOTE: Maximum of 26 turns (360°) of power adjustment nut. Closer is shipped at 11 turns from the factory.

## Standard Components

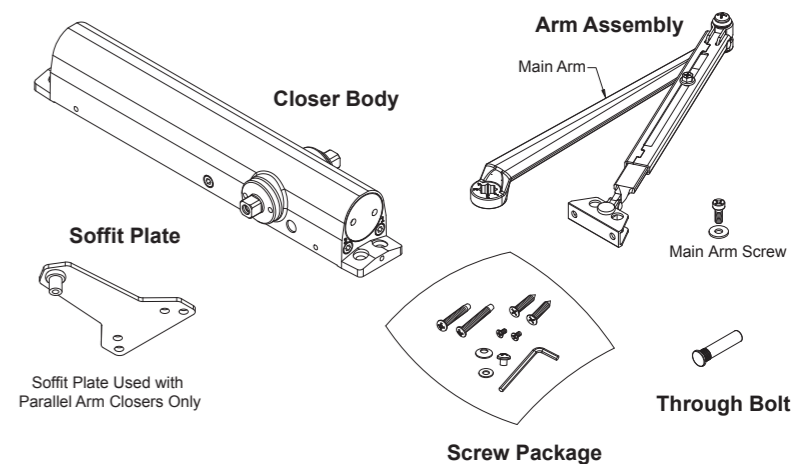

## Plastic Cover (optional)

